

POWER DRIVE WIDE-ANGLE JOINT

INNOVATIVE DETAILS FOR MAXIMUM DEPENDABILITY

- ▶ LONG SERVICE LIFE
- ▶ LOW MAINTENANCE EFFORT
- ▶ GREAT DEPENDABILITY
- ▶ LARGE CONSTANT ANGLES
- ▶ VERY QUIET RUNNING



▶ **LONG
SERVICE LIFE**

▶ **LOW
MAINTENANCE EFFORT**

▶ **GREAT
DEPENDABIL**



THE NEW MOBILITY OF POWER

The new generation of wide-angle joints from Walterscheid offers the user substantially greater benefits. It is characterised by numerous technical innovations that yield major advantages in practical use.

▶ **Readily accessible grease nipples**

The wide-angle joint has a new kind of central lubrication system which – in conjunction with the cap bottom lubrication that has already demonstrated its worth in standard joints – permits an optimum flow of grease straight to the heart of the joint.

▶ **40-hour maintenance interval**

Floating disks make for a permanently closed centring system. This minimises grease losses and prevents the ingress of dirt. As a result of this technical innovation, the new wide-angle joint only needs to be lubricated after every 40 hours of operation – generally meaning once per week.

▶ **Longer service life**

The floating disks and the spherical plain bearings integrated in the centring system ensure optimum distribution of forces. This reduces wear and prolongs the service life of the joint.

▶ **Great functional reliability**

The Power Drive wide-angle joint features the familiar product characteristics of the Walterscheid Power Drive range, such as dirt-repellent multi-lip seals and robust needle bearing technology. The completely enclosed design affords protection against environmental influences and the ingress of dust or residue of the harvested crop, for example. The new generation of wide-angle joints from Walterscheid is characterised by large constant angles and quieter running.

ITY

▶ LARGE
CONSTANT ANGLES

▶ VERY
QUIET RUNNING

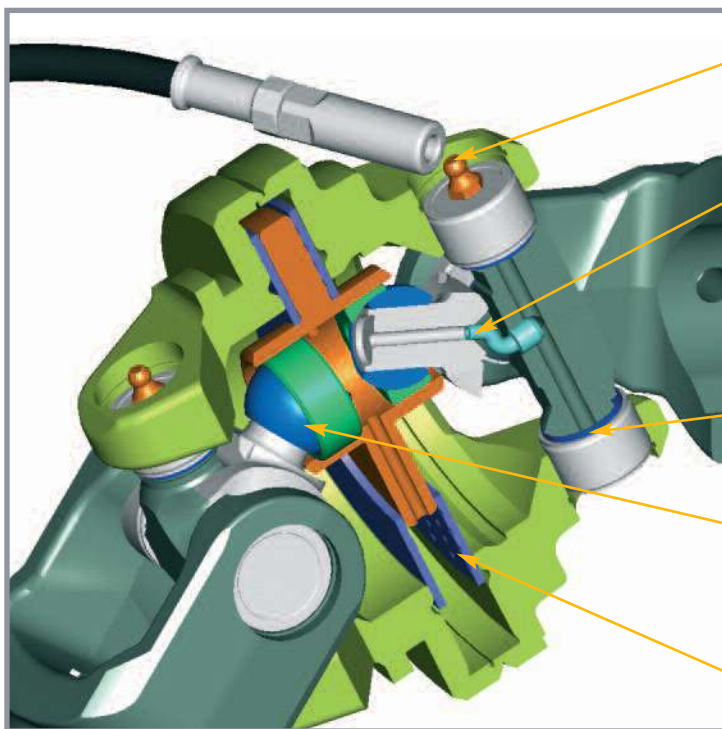

The new generation of wide-angle joints – Consistent advancement of time-proven technology.

Power Drive wide-angle joint

High-quality spherical plain bearings (1) reduce wear on the guide system. When the joint is angled, floating disks with grease chambers (2) prevent an opening forming, through which grease could escape and dirt particles could get in. This increases the service life of the guide system. The central lubrication system (3) supplies the joint with sufficient grease. The crosses are equipped with the blue P-seal (4). Cap bottom lubrication (5) facilitates greasing.

PERFORMANCE DATA AND DIMENSIONS – P480 & P580



Performance data:

Size	Limits		Dynamic capacity			
			1 540 rpm 1000 rpm		2 540 rpm 1000 rpm	
	Ms [Nm] (inlb)	Mp [Nm] (inlb)	P [KW] (PS/HP/CH)	Mn [Nm] (inlb)	P [KW] (PS/HP/CH)	Mn [Nm] (inlb)
P480	1430 (12660)	3800 (33630)	45 (61)	800 (7080)	71 (97)	1265 (11200)
			70 (95)	670 (5930)	110 (150)	1050 (9290)
P580	2470 (21860)	6000 (53100)	76 (103)	1350 (11950)	121 (165)	2140 (18940)
			117 (159)	1120 (9910)	186 (253)	1775 (15710)

1 Operating angle 10°
– Service life 1,000 h

2 Operating angle 18°
– Service life 100 h

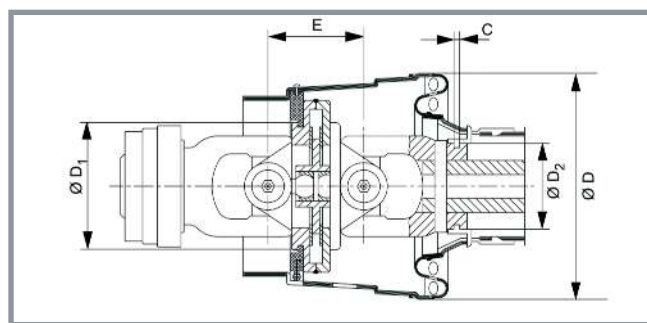
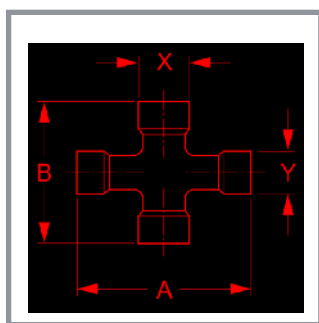

Dimensions (in mm):

Size	Cross				Double Yoke		Inboard yoke		Guard cone
	A	Y	B	X	E	∅D1	C	∅D2	D
P480	94	27	76	32	104	132	5	70	242
P580	106	32	89	36	118	138	5	70	242

We reserve the right to change designs without prior consultation. Use products only for the specified applications. We only guarantee constant quality. Reproduction, even in part, is only authorised with the written consent of Walterscheid GmbH.