

**MONTAGE- UND BETRIEBSANLEITUNG
INSTALLATION AND OPERATING INSTRUCTIONS
INSTRUCTIONS DE MONTAGE ET D'UTILISATION**

30.08.2021

ZUGZAPFENKUPPLUNG PB (PITONBOCK) 5300

PITON COUPLING PB 5300

ATTELAGE PITON PB 5300

WICHTIGE HINWEISE:

siehe separates Dokument BA_TASC_400002, www.walterscheid.com/downloads/

IMPORTATANT NOTES:

see separate document BA_TASC_400002, www.walterscheid.com/downloads/

NOTES IMPORTANTES:

voir document séparé BA_TASC_400002, www.walterscheid.com/downloads/

PITON COUPLING PB 5300

1. TECHNICAL DATA AND DESIGNATIONS

DESCRIPTION:

The piton-type coupling dimensions and field of application complying with ISO 6489-4, VO (EU) 2015/208 and regulation UN ECE R147, class h.

In its normal state, the device is in coupled and locked position.

The PB 5300 piton-type coupling can only be used in towing frames with quick-adjust height adjustment.

OPERATING RANGE:

For use on agricultural or forestry vehicles, self-propelled work machines or trailers.

TRAILER RINGS:

Suitable for connection to trailer rings according to ISO 5692-1, ISO 20019 (limited, see instructions of trailer ring) and UN ECE R147, class d50-1.

EC-TYPE APPROVAL No.:

e1*2009/144*0179

CHARACTERISTIC VALUES:

- > admissible D-Value: 89,3 kN
- > admissible vertical load: 3000 daN (kg)



IMPORTANT:

Attention must be paid to the D value and the maximum vertical load of the towing frame in this context. The lower value applies in each case.



NOTE:

If the valid national approval regulations of the respective country of use require additional official approvals for using these parameters, such approvals must be applied for.

For use of the coupling above the PTO, attention should be paid to the vehicle manufacturer's data regarding vertical loads.

VERSIONS AND DIMENSIONS:

(See Figure 1)

The piton-type coupling can be supplied in various dimensions according to the table below.

Type / Versions	Total width Dim. A	Guide width Dim. B	Pin-Ø- Dim. C	Guide spacing in towing frame	Guide width in towing frame	Hole -Ø in tow- ing frame
	[mm]	[mm]	[mm]	[mm]	[mm]	[mm]
PB 5293N	293	29,7	22,6	294	30	23
PB 5309N	309	29,7	22,6	310	30	23
PB 5311N	311	29,7	22,6	312	30	23
PB 5314N	314	30,0	20,0	315	30,5	20,7
PB 5322N	322	29,7	22,6	323	30	23
PB 5329N	329	31,7	25,0	330	32	26
PB 5329/30N	329	29,7	20,0	330	30	20,7
PB 5329/33N	329	33,7	22,6	330	34	23
PB 5335N	335	29,7	22,6	336	30	23

PB 5389N	389	31,7	25,0	390	32	26
----------	-----	------	------	-----	----	----

Table 1



IMPORTANT:

To avoid injury, protective gloves, safety glasses and safety shoes must be worn during all dismantling/ assembly actions described in this chapter.



Environment:

Lubricants can enter the environment. Environmental pollution: Collect, store and correctly dispose of lubricants in suitable containers.

2. INSTALLATION:

(See Figure 2)



NOTE:

The pertinent regulations (e.g. Accident Prevention Regulations for Vehicles) and the attachment guidelines of the vehicle manufacturers must be observed when installing the coupling!

The attachment of the coupling to the vehicle must be carried out in accordance with the requirements of regulation (EU) 2015/208, appendix 34.



NOTE:

Official national regulations must be observed. For example: in Germany the obligations §13 FZV regarding the data in the car license concerning the permissible trailer weight as well as the permissible vertical load must be considered.

ATTACHMENT OF THE PITON-TYPE COUPLING TO THE TOWING FRAME:

- > Remove the lynch pins (4) of the locking pins (3) and pull out the pins.
- > Push piton-type coupling (1) from above into the slots of the guide rails of the coupling frame.
- > Hold on the desired height position in the coupling frame and fix it by the locking pins (3).
- > Possibly, it is necessary to remove an existing fall protection in the coupling frame (screw M12, spring pin or similar). This must be reattached when the piton frame is removed.
- > Fix the locking pins (3) by the lynch pins (4) reciprocally.
- > The guide of the slider (120 mm long, see figure 1) must not project beyond the guide slots of the frame, both above and down.



WARNING:

The pertinent safety regulations must be observed when coupling and uncoupling.

No one may stand between the vehicles. The coupling may only be operated in locked condition.

3. DESCRIPTION, OPERATION AND MAINTENANCE:

See attachment or separate document BA_TASC_400031, www.walterscheid.com/downloads/



**WARNING:
SAFETY NOTES:**

- > The user is obliged to always operate the coupling in perfect condition and to forbid its use by unauthorised persons.
- > The loads indicated on the type plate may not be exceeded.
- > Unauthorised conversion or modification of the coupling is not permitted.

4. CALCULATION OF CHARACTERISTIC VALUES FOR CORRECT OPERATION OF THE COUPLING ON AGRICULTURAL AND FORESTRY VEHICLES

See attachment or separate document BA_TASC_400029, www.walterscheid.com/downloads

BILD 1
FIGURE 1

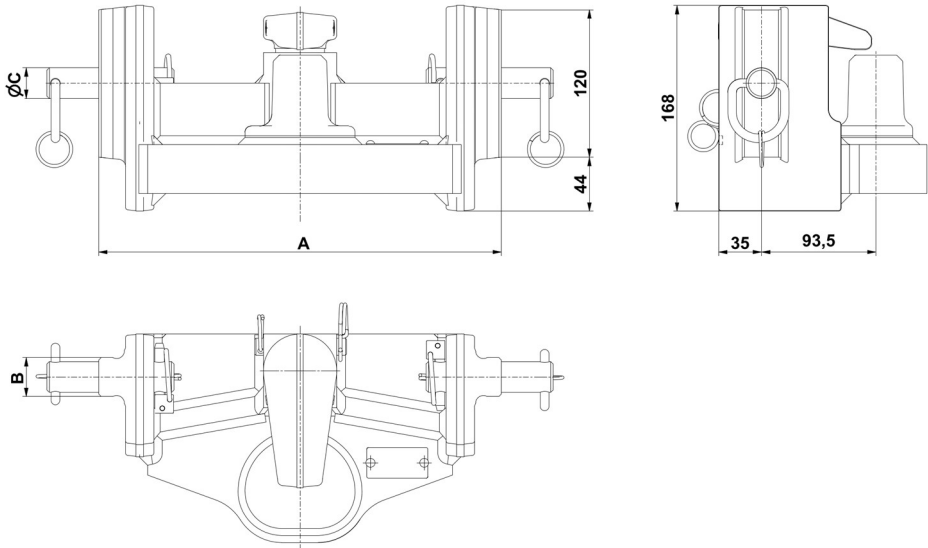

Abmessungen
Dimensions

BILD 2
FIGURE 2

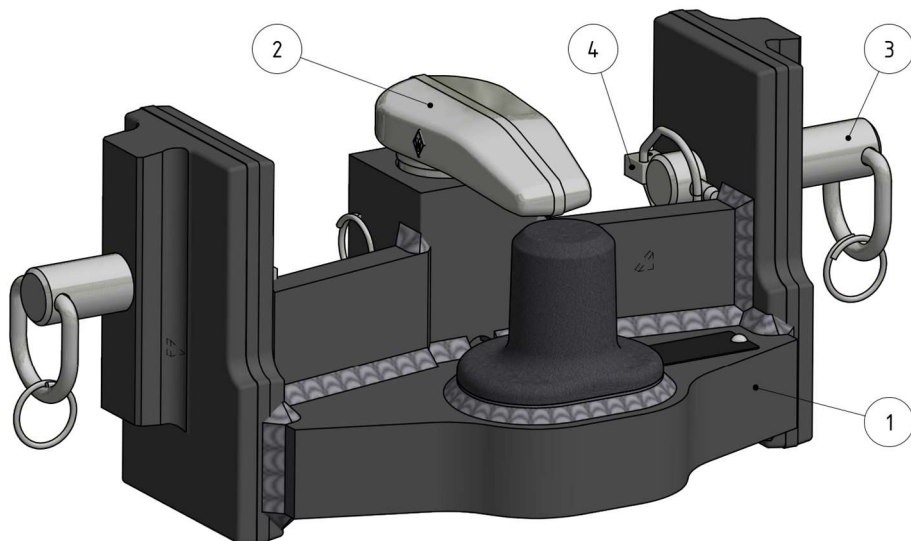

Pitonbock PB5300
Piton Coupling PB5300
Attelage Piton PB5300

Legende:

- 1 Kugelbock
- 2 Niederhalter
- 3 Absteckbolzen
- 4 Klappstecker

Legend:

- 1 ball-type coupling
- 2 retainer
- 3 locking pin
- 4 linch pin

Légende:

- 1attelage piton
- 2Dispositif de retenue
- 3boulons de blocage
- 4goupille