

**MONTAGE- UND BETRIEBSANLEITUNG
INSTALLATION AND OPERATING INSTRUCTIONS
INSTRUCTIONS DE MONTAGE ET D'UTILISATION**

18.03.2022

AUTOMATISCHE FLANSCHKUPPLUNG KU 714 UND 740

AUTOMATIC FLANGE COUPLING KU 714 AND 740

ATTELAGE DE REMORQUE AUTOMATIQUE À BRIDE KU 714 ET 740

WICHTIGE HINWEISE:

siehe separates Dokument BA_TASC_400002, www.walterscheid.com/downloads/

IMPORTATANT NOTES:

see separate document BA_TASC_400002, www.walterscheid.com/downloads/

NOTES IMPORTANTES:

voir document séparé BA_TASC_400002, www.walterscheid.com/downloads/

AUTOMATIC FLANGE COUPLING KU 714 AND 740

1. TECHNICAL DATA AND DESIGNATIONS:

DESCRIPTION:

The coupling is an automatic trailer coupling, its clevis dimensions and field of application complying with DIN 11029.

Its design incorporates the lever trigger system, i.e. the coupling procedure is triggered by moving a trailer ring into the clevis and pressing back the trigger lever. In its normal state, the coupling is in closed and locked position.

The automatic trailer coupling can be pivoted through 360°, the torque required for this purpose being 100 - 150 Nm.

OPERATING RANGE:

For use on agricultural or forestry vehicles, self-propelled work machines or trailers.

TYPE APPROVALS AND CHARACTERISTIC VALUES:

Versions, admissible D value and a static vertical load at the coupling point in accordance with the following list:

KU 714: GERMAN APPROVAL NR.: F 3273

CHARACTERISTIC VALUES:

- > Adm. D-value: 45,0 kN
- > Adm. total weight of the tractor: 5250 kg
- > Adm. vertical force: 1250 daN (kg)

> Max. speed: 40 km/h

Only for mounting on trailers:

- > Adm. total weight of the trailer: 9000 kg
- > Adm. vertical force: 1250 daN (kg)
- > Max. speed: 40 km/h

KU 740: GERMAN APPROVAL NR.: F 3171

CHARACTERISTIC VALUES:

- > Adm. D-value: 65,0 kN
- > Adm. total weight of the tractor: 8500 kg
- > Adm. vertical force: 2000 daN (kg)

> Max. speed: 40 km/h

Only for mounting on trailers:

- > Adm. total weight of the trailer: 13000 kg
- > Adm. vertical force: 2000 daN (kg)
- > Max. speed: 40 km/h



NOTE:

If the valid national approval regulations of the respective country of use require additional official approvals for using these parameters, such approvals must be applied for.

For use of the coupling above the PTO, attention should be paid to the vehicle manufacturer's data regarding vertical loads.

VERSIONS AND FLANGES KU714:

(see figure 2)

| Versions | Coupling pin Ø | Hole pattern A x B | Hole dia. C | Fastening screws | Flange dimensions D x E | Width of clevis |
|-----------|----------------|--------------------|-------------|------------------|-------------------------|-----------------|
| | [mm] | [mm] | [mm] | | [mm] | [mm] |
| KU 9142A | 32 | 120x55 | 15 | M 14 | 155x90 | 155 |
| KU 9142B | 32 | 106x65 | 15 | M 14 | 155x90 | 155 |
| KU 9148A | 38 | 120x55 | 15 | M 14 | 155x90 | 155 |
| KU 9148B | 38 | 106x65 | 15 | M 14 | 155x90 | 155 |
| KU 9142AC | 32 | 120x55 | 15 | M 14 | 155x90 | 200 |
| KU 9142BC | 32 | 106x65 | 15 | M 14 | 155x90 | 200 |
| KU 9148AC | 38 | 120x55 | 15 | M 14 | 155x90 | 200 |
| KU 9148BC | 38 | 106x65 | 15 | M 14 | 155x90 | 200 |

VERSIONS (= ORDER DESIGNATION) KU 914:

(see figure 1)

The versions are always expressed as: KU 914xY, with x representing the type of pin (2 = pin with dia. 32 mm, 8 = pin with dia. 38 mm) and Y representing the version A or B. For use on trailers, the versions with code letter C are to be used.

Example: KU9142AC

KU9142A = Flange coupling of the KU 714 series with pin dia. 32 mm and flange size A (120x55)
C = for use on trailers

VERSIONS AND FLANGES KU740:

(see figure 2)

| Versions | Coupling pin Ø | Hole pattern A x B | Hole dia. C | Fastening screws | Flange dimensions D x E | Width of clevis |
|-----------|----------------|--------------------|-------------|------------------|-------------------------|-----------------|
| | [mm] | [mm] | [mm] | | [mm] | [mm] |
| KU 9402A | 32 | 140x80 | 17 | M 16 | 180x120 | 155 |
| KU 9402B | 32 | 160x100 | 21 | M 20 | 180x120 | 155 |
| KU 9408A | 38 | 140x80 | 17 | M 16 | 180x120 | 155 |
| KU 9408B | 38 | 160x100 | 21 | M 20 | 180x120 | 155 |
| KU 9402AC | 32 | 140x80 | 17 | M 16 | 180x120 | 200 |
| KU 9402BC | 32 | 160x100 | 21 | M 20 | 180x120 | 200 |
| KU 9408AC | 38 | 140x80 | 17 | M 16 | 180x120 | 200 |
| KU 9408BC | 38 | 160x100 | 21 | M 20 | 180x120 | 200 |

VERSIONS (= ORDER DESIGNATION) KU 940:

(see figure 1)

The versions are always expressed as: KU 940xY, with x representing the type of pin (2 = pin with dia. 32 mm, 8 = pin with dia. 38 mm) and Y representing the version A or B. For use on trailers, the versions with code letter C are to be used.

Example: KU9402AC

KU9402A = Flange coupling of the KU 740 series with pin dia. 32 mm and flange size A (140x80)

C = for use on trailers

TRAILER RINGS:

All versions are suitable for connection to trailer rings according to DIN 74054 (ISO 8755).



IMPORTANT:

To avoid injury, protective gloves, safety glasses and safety shoes must be worn during all dismantling/ assembly actions described in this chapter.

Environment:

Lubricants can enter the environment. Environmental pollution: Collect, store and correctly dispose of lubricants in suitable containers.

2. INSTALLATION:



NOTE:

The pertinent regulations (e.g. Accident Prevention Regulations for Vehicles) and the attachment guidelines of the vehicle manufacturers must be observed when installing the coupling!

The attachment of the coupling to the vehicle must be carried out in accordance with the requirements of regulation (EU) 2015/208, Appendix 34.



NOTE:

Official national regulations must be observed. For example: in Germany the obligations §13 FZV regarding the data in the car license concerning the permissible trailer weight as well as the permissible vertical load must be considered.

ATTACHMENT OF THE COUPLING:

The coupling is attached to the vehicle by means of 4 bolts according to DIN EN 24014, DIN EN 24017 or ISO 4762. They are to be tightened crosswise. A torque wrench must be used to obtain the correct tightening torque. Normally the bolts are not included in the scope of supply. Therefore the data of the vehicle manufacturers are to be preferred for attachment.

If there are no specifications see separate document BA_TASC_400038, www.walterscheid.com/downloads/



WARNING:

The pertinent safety regulations must be observed when coupling and uncoupling.

No one may stand between the vehicles. The coupling may only be operated in locked condition.

3. DESCRIPTION, OPERATION AND MAINTENANCE:

See attachment or separate document BA_TASC_400040, www.walterscheid.com/downloads/



WARNING:
SAFETY NOTES:

- > The user is obliged to always operate the coupling in perfect condition and to forbid its use by unauthorised persons.
- > The loads indicated on the type plate may not be exceeded.
- > Unauthorised conversion or modification of the coupling is not permitted.

4. CALCULATION OF CHARACTERISTIC VALUES FOR CORRECT OPERATION OF THE COUPLING ON AGRICULTURAL AND FORESTRY VEHICLES

See attachment or separate document BA_TASC_400029, www.walterscheid.com/downloads

BILD 1
FIGURE 1



Typ / type: KU 9402A

BILD 2
FIGURE 2

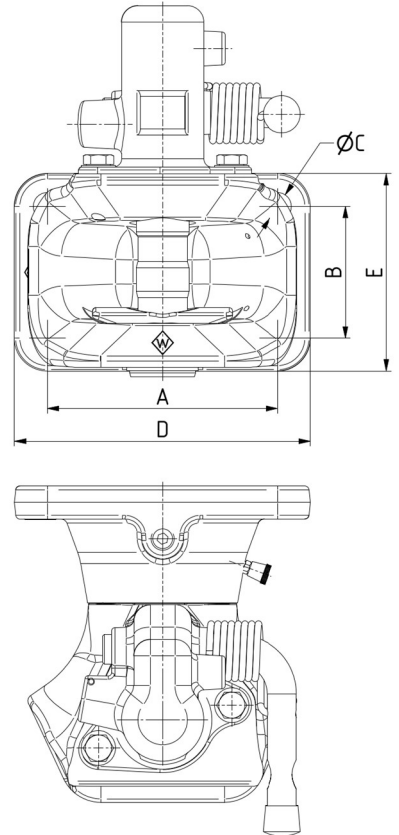

Abmessungen / dimensions